

SOL Mate

Installation Guide for SOL-Mate Closure Tool Kit

www.solmate.net

Korea +82-70-4628-5248

jaykim@soltech.co.kr

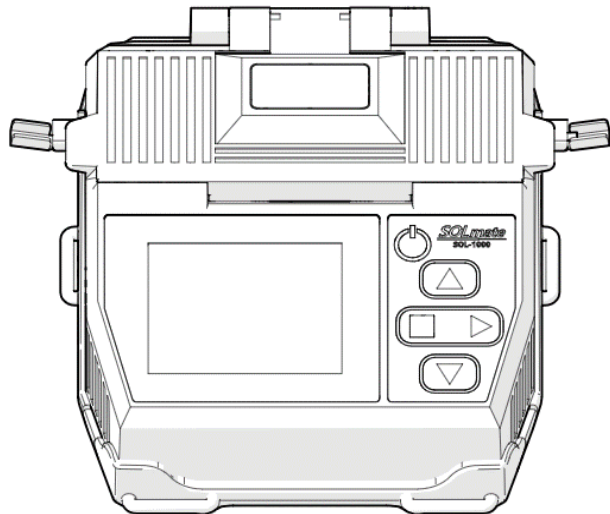

중간 접속자 이미지

Table of Contents

Introduction	V
Safety Precautions	VI
1. Getting Started	1
1.1. General	1
1.2. SOL-Mate Connector Maker Tool Kit Contents	1
1.3. SOL-Mate Connectors and Ordering Information	2
2. Overview of Installation Tools	4
2.1. SOL-Mate Connector Maker Installation Tool	4
2.2. FC-01 Cleaver	6
3. Tool and Connector Preparation	7
3.1. Tool Preparation	7
3.2. Connector Preparation	8
4. Fiber Preparation	9
4.1. Cable and boot type divisions	9
4.2. Screw Type Boots for Flat type Drop Cable	10
4.3. Screw Type Boots for Round Type Drop Cable	12
4.4. Soft Type Boots for Patch Coad	14
4.5. Soft Type Boots for Tight Buffer	18

5.	Fiber Cleaving with FC-01 Cleaver	19
	5.1. Cleaving Procedure	19
6.	Connector Splicing	20
	6.1. Splicing Settings	20
	6.2. Splicing connectors	21
7.	Connector Assembly.	23
	7.1. Screw Type Boots Assembly	23
	7.2. Soft Type Boots Assembly	24
	7.3. Tight Buffer Soft Boots Assembly	26
8.	Maintenance and Troubleshooting.	27
	8.1. Safety Precautions	27
	8.2. SOL-1000 Battery Charging	29
	8.3. Electrode Settings	30
	8.4. Electrode Management and Replacing	31
	8.5. FC-01 Fiber Cleaver Maintenance	32
	8.6. Lenses and V-Groove Management	33
	8.7. Troubleshooting	34

8.2 Connector preparation

3.2.1 Connector Precautions

When the connector head is released from case, the connector fiber will be exposed easily to be damaged. The connector head should be promptly inserted to the holder after released to avoid any damages to be caused.

3.2.2 Connector Loading

- Step 1 :** Open the connector holder head
- Step 2 :** Peel the sealed connector head case and carefully pick the connector
- Step 3 :** Input the connector head to the case.
 - ◎ Wing sleeve sticker should head up on the holder
 - ◎ The fiber on the connector head should not be touched or contacted during all process.
- Step 4 :** Close the connector holder head
- Step 5 :** Carefully load the holder to the left movement holder pin of SOL-1000
 - ◎ Holder should be vertically placed to SOL-1000

3.2.3 Connector Loading checkup

After loading the connector holder to SOL-1000, check if the connector fiber is well reaching the V-Groove area.

- ◎ If the fiber short, replace the connector head with a new product and repeat from start

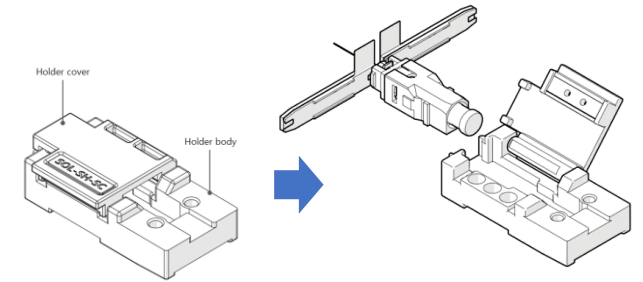

Figure 3.2.1 Input the connector head to the holder

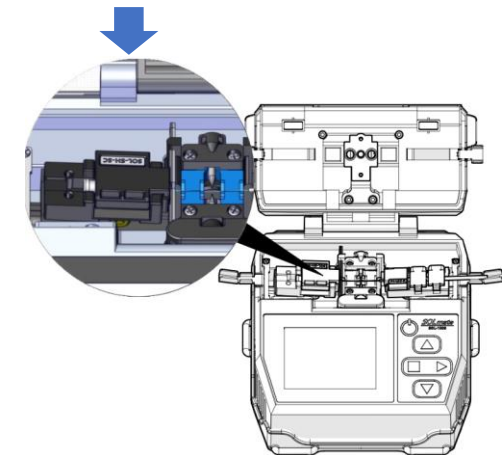
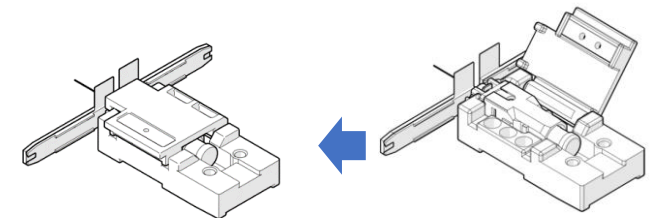

Figure 3.2.3 Inserted Connector holder

9. SOL-200 series , Closure preparation

9.1

All assembly process for connectors are different depending to the cable and boot types. Cable and boot type is categorized as below.

Cable Type Boot Type	2x3 mm Flat Drop cable	3 mm Round Drop Cable	900 μ m Tight Buffer	2 mm Round Patch Cord	3 mm Round Patch Cord
Soft Tight buffer (SC / LC)	-	-	○	-	-
Soft Type boot (SC / LC)	-	-	-	○	○
Screw Type boot (SC)	○	○	-	-	-
Closure Set	○	○	-	-	-

